



MODERN PLASTIC INDUSTRY L.L.C.

UPVC DUCT PIPES & FITTINGS



— Reliability, Quality and Value —



PROFILE

Introduction

Modern Plastic Industry is a part of AL SHIRAWI GROUP OF COMPANIES which is one of the largest and most diversified business conglomerates in the Arabian Gulf. From its inception in 1971 as a trading and contracting company, the Group has broadened its scope to encompass a cross section of products, services and industries ranging from printing, heavy fabrication, engineering, electromechanical, electronics, trucks and logistics.

Established in 1987, Modern Plastic Industry (MPI) has pioneered the manufacturing of UPVC pressure, duct & sewerage pipe fittings in UAE. Today Modern Plastic has a wide range of SWR drainage, high pressure UPVC, CPVC, PP Compression Fittings and Pipes.

MPI products have been used extensively in the irrigation, construction, plumbing, electrical sleeves and landscaping industry and are playing a significant role in the development of the Gulf region and Middle East.

State-of-the-art facility

MPI UPVC Pressure Pipes and Fittings systems are manufactured in a state-of-the-art facility at Dubai Investment Park with state-of-the-art Microprocessor based Injection Moulding Machines and High Quality Precision Moulds for Fittings and High Quality Extrusion Machines for Pipes.

Technology is the backbone of ongoing development and the right design selection headed by a team of experienced and well-trained professionals complements the development process.

MPI has established an in-house tool room with the latest CNC machines and EDM machines, which are used to manufacture moulds as per the needs of the market.

Quality Control

As the UPVC High Pressure Pipe Fitting systems are specially designed to meet the harsh climate conditions of the Gulf region, MPI places emphasis on Quality, Reliability and Economy. Strict in-house Quality Control is backed by testing through independent laboratories of international repute to certify the quality of pipes and fittings.

MPI places great emphasis on customer satisfaction through quality products. The company's operational excellence is evident through its established Quality Management System, which complies with the ISO 9001-2008 standard, certified by British Standard Institute (BSI) UK. Also the company's product have been awarded the prestigious Kitemark certification of BSI, UK.





In-House Quality Control

MPI's Products are tested to maintain the quality level in the permissible standard tolerances. We perform the tests as per relevant international standards (BS, DIN, ISO) and acceptance sampling procedures for production quality control and lot testing are done during all production operations.

The following quality control tests are performed in our in-house lab.

- Physical Test
- Dimensional Check
- Pressure Test
- Impact Test
- Heat Reversion test / Effect on Heating Test
- Dichloromethane test
- Vicat Softening Temperature Test
- Opacity Test

Apart from this, our products are being tested / assessed by BSI / other certification bodies on a regular basis.

A Complete Solution

With the growing demand to cater to the construction industry MPI has now introduced a complete range of UPVC Duct Pipes and Fittings fabricated out of the same pipes conforming to BS 3506 . DIN 8062 standards.

MPI's products are manufactured par excellence to the international standards and ensure a complete solution of "Piping System" for plumbing applications.

Global Presence

MPI has been the leader in the Gulf market mainly because it can offer the widest range of UPVC Pressure, Drainage and Duct Pipes and Fittings which are specially designed to meet theharsh climatic conditions with more emphasis of Quality, Reliability and Economy. MPI is managed by a team of experienced and well trained professionals, and markets its range of products in the AGCC region, the Middle East, Africa, Europe and the Asian subcontinent.



DIMENSIONS OF DUCT PIPE

DUCT PIPE AS PER DIN 8062 STANDARD (MILLIMETER SIZE)

Size	Mean Outside Dia		WALL THICKNESS					
			PN - 10 (CLASS-10)		PN - 6 (CLASS-6)		PN - 4 (CLASS-4)	
	Min	Max	Min	Max	Min	Max	Min	Max
25 mm	25.00	25.20	1.50	1.90	-	-	-	-
32 mm	32.00	32.20	1.80	2.20	-	-	-	-
40 mm	40.00	40.20	1.90	2.30	1.80	2.20	-	-
50 mm	50.00	50.20	2.40	2.90	1.80	2.20	-	-
63 mm	63.00	63.20	3.00	3.60	1.90	2.30	-	-
75 mm	75.00	75.30	3.60	4.20	2.20	2.70	1.80	2.20
90 mm	90.00	90.30	4.30	5.00	2.70	3.20	1.80	2.20
110 mm	110.00	110.30	5.30	6.10	3.20	3.80	2.20	2.70
160 mm	160.00	160.40	7.70	8.70	4.70	5.40	3.20	3.80
200 mm	200.00	200.40	9.60	10.80	5.90	6.70	4.00	4.70
250 mm	250.00	250.50	11.90	13.30	7.30	8.30	4.90	5.60
315 mm	315.00	315.60	15.00	16.70	9.20	10.40	6.20	7.10

DUCT PIPE AS PER BS 3506 STANDARD (INCH SIZE)

Size	Mean Outside Dia		WALL THICKNESS					
			PN - 12 (CLASS-D)		PN - 9 (CLASS-C)		PN - 6 (CLASS-B)	
	Min	Max	Min	Max	Min	Max	Min	Max
1 1/4"	42.10	42.40	2.20	2.70	-	-	-	-
1 1/2"	48.10	48.40	2.50	3.00	-	-	-	-
2"	60.20	60.50	3.10	3.70	2.50	3.00	-	-
2 1/2"	75.00	75.30	3.90	4.50	3.00	3.50	-	-
3"	88.70	89.10	4.60	5.30	3.50	4.10	2.90	3.40
4"	114.10	114.50	6.00	6.90	4.50	5.20	3.40	4.00
6"	168.00	168.50	8.80	10.20	6.60	7.60	4.50	5.20
8"	218.80	219.40	10.30	11.90	7.80	9.00	5.30	6.10
10"	272.60	273.40	12.80	14.80	9.70	11.20	6.60	7.60
12"	323.40	324.30	15.20	17.50	11.50	13.30	7.80	9.00

DUCT PIPE - ELECTRICAL AND TELEPHONE CABLE

Size	Mean Outside Dia		WALL THICKNESS	
	Min	Max	Min	Max
54 Duct Pipe	96.30	96.70	3.25	3.65
56 Duct Pipe	53.80	54.00	1.55	1.70

Note: All the dimensions are in millimeter



DUCT PIPE AS PER EN 1452 (Metic Series)

Size	Mean Outside Dia		WALL THICKNESS					
			PN - 16 (CLASS-16)		PN - 10 (CLASS-10)		PN - 6 (CLASS-6)	
	Min	Max	Min	Max	Min	Max	Min	Max
50	50	50.2	3.7	4.3	2.4	2.9	1.6	2
63	63	63.2	4.7	5.4	3	3.5	2	2.4
75	75	75.3	5.6	6.4	3.6	4.2	2.3	2.8
90	90	90.3	6.7	7.6	4.3	5	2.8	3.3
110	110	110.3	6.6	7.5	4.2	4.9	2.7	3.2
160	160	160.4	9.5	10.7	6.2	7.1	4	4.6
200	200	200.4	11.9	13.3	7.7	8.7	4.9	5.6
250	250	250.4	14.8	16.5	9.6	10.8	6.2	7.1
315	315	315.6	18.7	20.8	12.1	13.6	7.7	8.7

TECHNICAL SPECIFICATION

DUCT Pipes are manufactured as per DIN 8062 and BS 3506 standards.

Length

The standard length shall be 6m with socket or as per customer requirement.

Colour

The colour of the pipe shall be Grey / Black or as per customer requirement.

Bends

Short radius and Long radius 22.5° , 45° , 90°

Junctions

Square and Sweep Tees, Crosses and Fittings, Double Sockets, Bellmouths, End Caps.

GENERAL PROPERTIES

Specific Gravity : 1.41

Vicat Softening Temperature : Min 80°C

Tensile strength : > 45 MN/ sq cm at 20°C

Flammability : UPVC is self extinguishing and will not support combustion

Specific heat : 1040 J/ Kg / °C

APPLICATIONS

Used in Telephone Cables, High voltage underground cables, street and housing power supplies, factory and industrial applications, sheathing of water and gas services.



UPVC DUCT PIPES AND FITTINGS

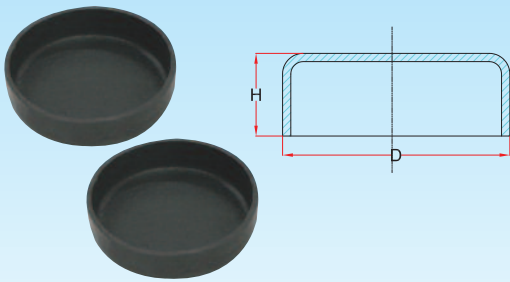

1) Duct End Caps

Size	Inside Diameter (D)	Height (H)
2" / 63mm	60.50 / 63.20	30
2 1/2" / 75mm	75.30	30
3" / 90 mm	89.10 / 90.30	30
4" / 110mm	114.50 / 110.30	30
6" / 160mm	168.50 / 160.40	40
8" / 200mm	218.00 / 200.60	45

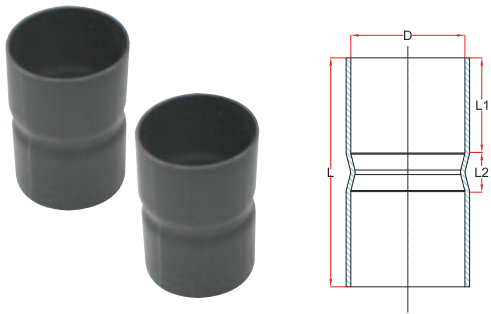

2) Duct Socket

Size	Inside Diameter (D)	Length (L)
2" / 63mm	60.50 / 63.20	116.5
2 1/2" / 75mm	75.30	140
3" / 90 mm	89.10 / 90.30	162
4" / 110mm	114.50 / 110.30	172
6" / 160mm	168.50 / 160.40	258
8" / 200mm	218.00 / 200.60	294

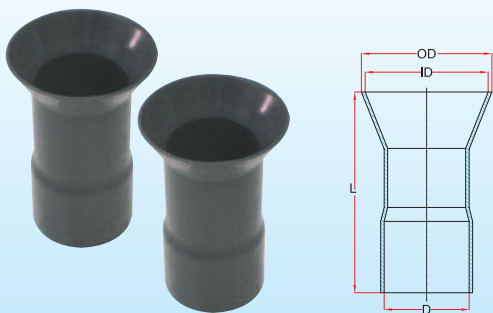

3) Duct Bellmouth

Size	(ID)	(OD)	(L)
2" / 63mm	110	117	169
3" / 90 mm	161.5	168	222
4" / 110mm	201	212	265
6" / 160mm	250.5	265	340
8" / 200mm	315	332	370

Note: All the above product are made as per pipe specification. All the dimensions are in millimeter.



UPVC DUCT PIPES AND FITTINGS

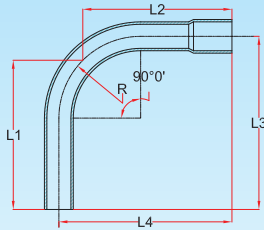

4) Duct 45° / 90° Long Radius Bend

Size	Radius ' (R)	Length (L1 / L2)	Length (L3 / L4)
2" / 63mm	300	481	567
3" / 90 mm	400	638	755
4" / 110mm	400	626	683
6" / 160mm	400	699	717
8" / 200mm	600	914	1090

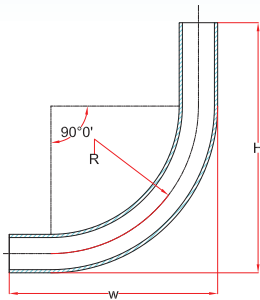

5) Duct 90° Street Lighting Long Radius Bend 4"

Size	Poles	Radius ' (R)	H / W
4"	12 Mtr	600	1050 / 600
4"	14 Mtr	600	1050 / 600
4"	16 / 18 Mtr	600	1070 / 600
4"	25 Mtr	600	1150 / 1150

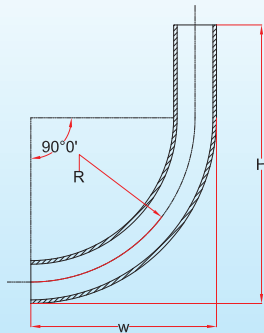

6) Duct 90° Street Lighting Long Radius Bend 3"

Size	Poles	Radius ' (R)	H / W
3"	3.5 Mtr	600	700 / 600
3"	5 Mtr	600	700 / 600
3"	6 Mtr	600	1050 / 600
3"	8 Mtr	600	1050 / 600
3"	10 Mtr	600	1050 / 600

Note: All the above product are made as per pipe specification. All the dimensions are in millimeter.



WHY CHOOSE MODERN PLASTIC INDUSTRY LLC?

- Proven research capability and ability to provide products to suit customer application needs.
- UPVC duct pipe & fittings system which offers quality & reliability at a competitive price.
- Technical service and installation backup.
- One stop facility - wide range of pipes & fittings.
- Prompt deliveries - inhouse manufacturing facilities for all the pipes and fittings in UAE.
- Quality and reliability - according to international standards.
- Operational excellence - precision manufacturing according to the standards using state of the art machinery.
- Duty exemption in GCC countries.
- Service - 24 hours customer service.



MODERN PLASTIC INDUSTRY L.L.C.

P.O. Box 31550, Dubai U.A.E. Tel: +971 4 885 1300 • Fax: +971 4 885 1302 / 885 1301

E-mail: marketing@mpi.ae • Website: www.mpi.ae